

CKPG05 - PEUGEOT EW10 J4 2.0 - TBP45 KIT

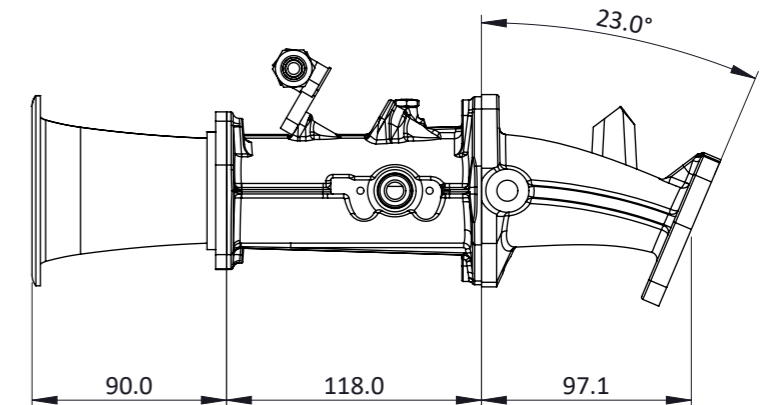

Engineered to win

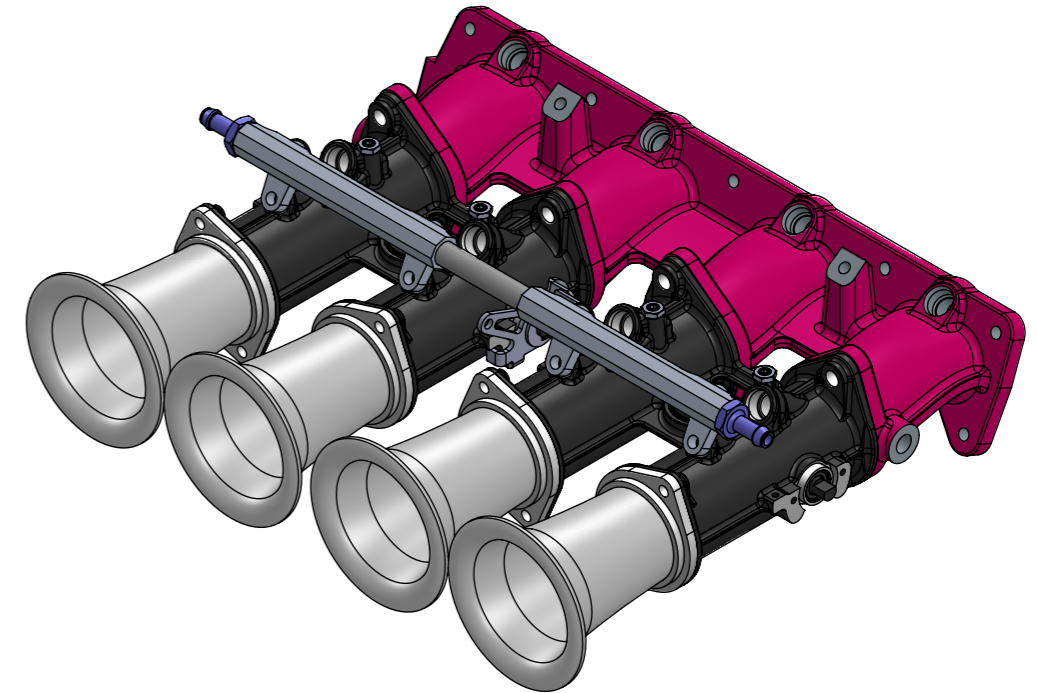
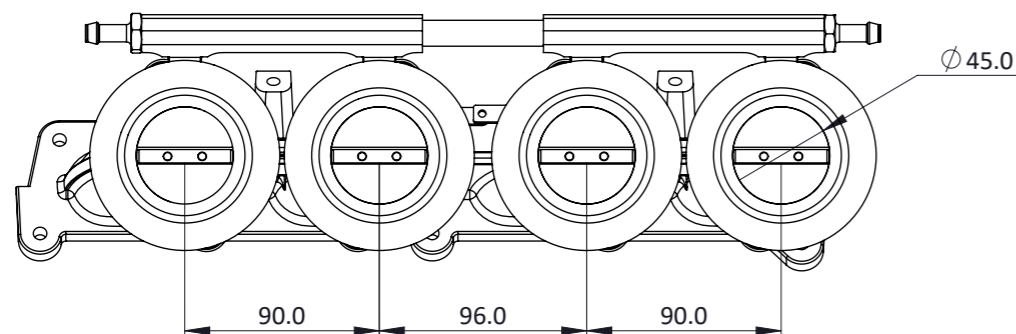
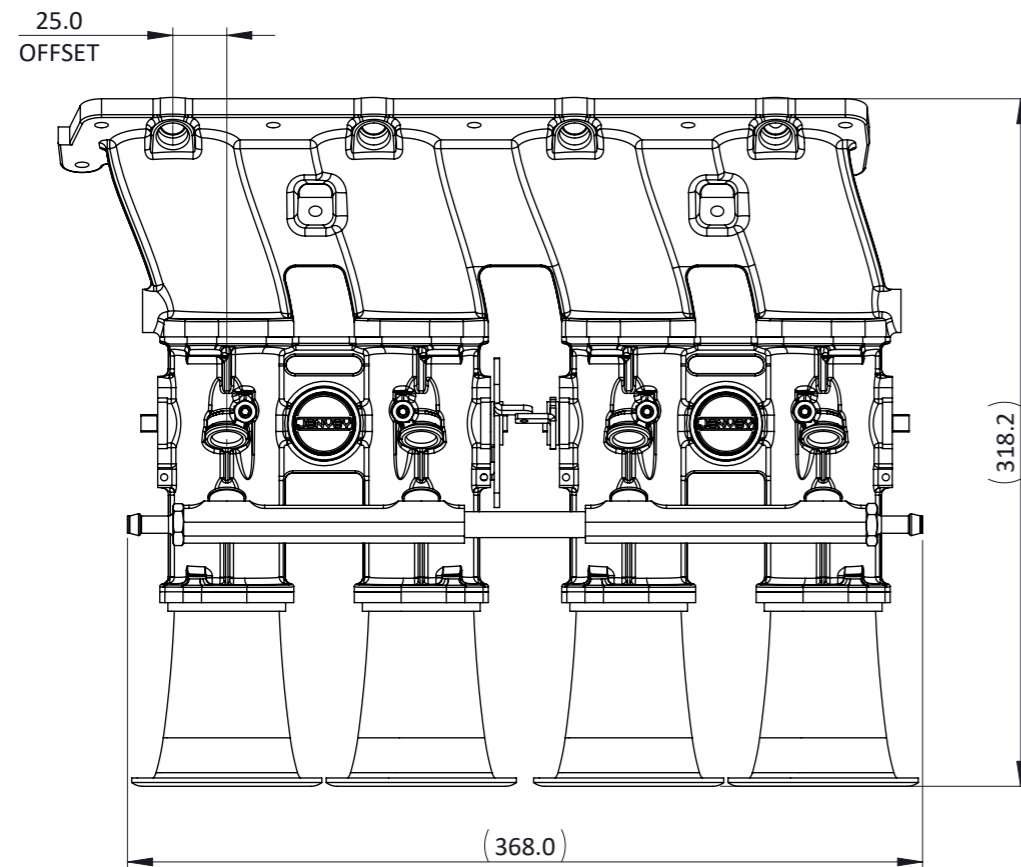
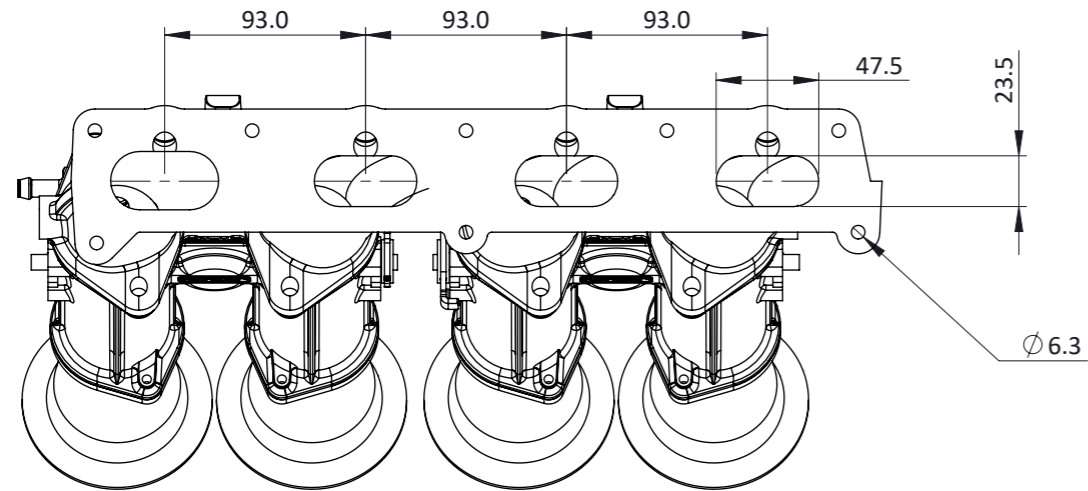

A kit for the Peugeot/Citroen 2.0 engine - EW10 J4 - as used in the 206 GTi which contains an inlet manifold, a pair of TB45's, fuel rail and 90mm long airhorns. Curved to miss the power steering system. Also fits the EW10J4s (GTI180 & RC) although porting will be required and there is no provision for the inlet manifold oil take-offs.

Frame: 1 of 1

Version:

Tel 01746 768810

© JENVEY DYNAMICS LTD. 2015

Web WWW.JENVEY.CO.UK

